

# INSTRUCTION MANUAL

## SMART SECURITY LIGHT

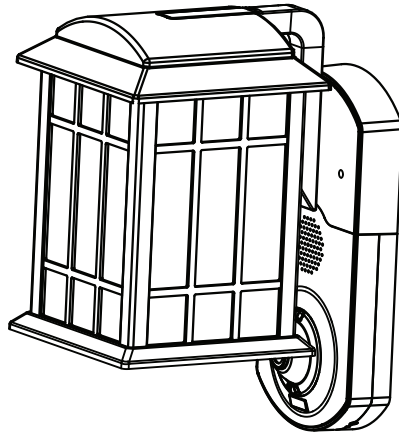

Questions, problems, missing parts? Before returning to the store,  
call KUNA Customer Service  
9:30 a.m. - 6:30 p.m., EST, Monday - Friday

# PACKAGE CONTENTS

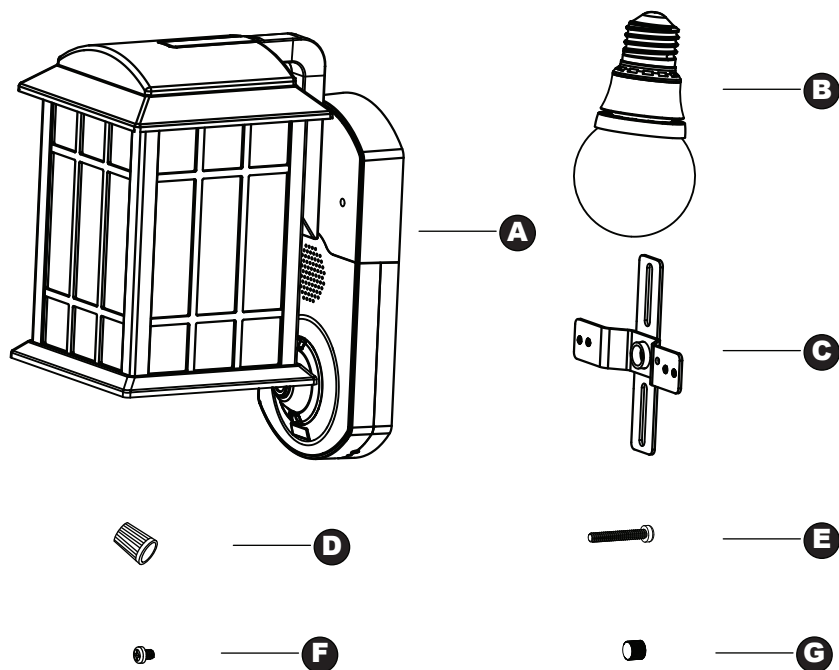

Part	Description	Quantity
A	Fixture	1
B	LED Bulb	1
C	Bracket	1
D	Wire Nut	2
E	Long Screw	2
F	Short Screw	2
G	Nut	2

# SAFETY INFORMATION

## WARNING

- Risk of fire or electric shock. LED light installation requires knowledge of luminaire electrical systems. If not qualified, do not attempt to install. Contact a qualified electrician.
- Disconnect power at fuse or circuit breaker before installing or servicing.
- No user serviceable parts inside. To avoid electrical shock, do not disassemble product.
- To prevent wiring damage or abrasion, do not expose wiring to edges of sheet metal or other sharp objects.
- Installers should not disconnect existing wires from lampholder terminals to make new connections at lampholder terminals. Instead, installers should cut existing lampholder leads away from the lampholder and make new electrical connections to lampholder leads by employing applicable connectors.

## CAUTION

- Turn power off before inspection, installation or removal.
- Use only on 120 V AC, 60 Hz circuits.
- This device complies with Part 15 of the FCC rules and has been tested and found to comply with the limits for a Class B digital device. These limits are designed to provide reasonable protection against harmful interference in a residential installation. This equipment generates, uses and can radiate radio frequency energy, and if not installed or used in accordance with the instructions may cause harmful interference to radio communications.

# PREPARATION

- Before beginning assembly of product, make sure all parts are present. Compare parts with package contents list. If any part is missing or damaged, do not attempt to assemble the product.

# INSTALLATION

1. Lock two long screws into outer holes of bracket.

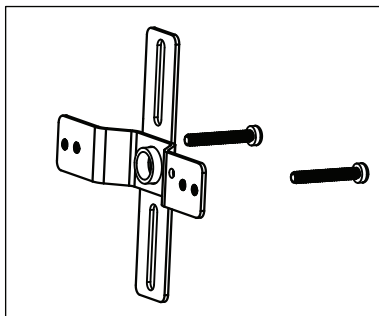

2. Fasten the bracket onto the wall junction box with two short screws.

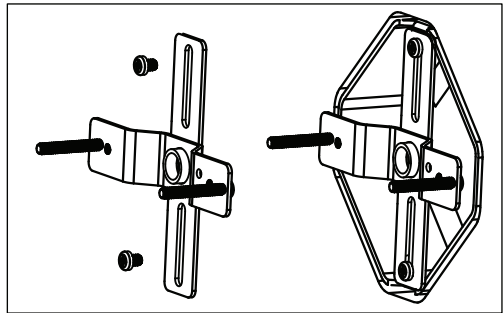

3. Connect wires of fixture and junction box together with two wire nuts.

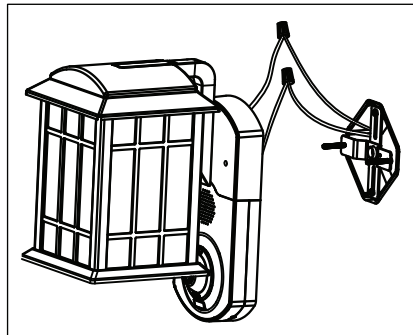

4. Fix the fixture onto two long screws, tighten with two nuts.

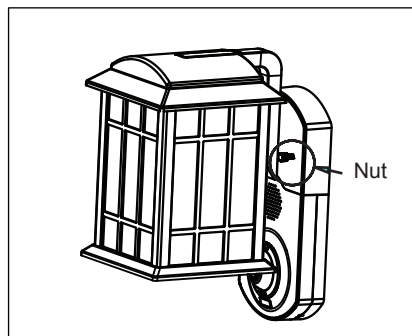

5. Rotate the bulb anticlockwise into lamp base inside fixture until it's fixed.

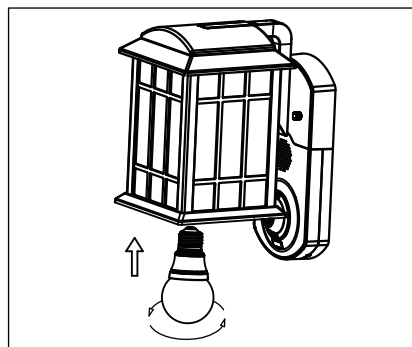

## WARRANTY

If this product fails due to a defect in material or workmanship within two (2) years from the date of purchase, return it along with proof of purchase to the store and it will be replaced with the same or comparable model, free of charge. This warranty gives you specific legal rights and you may have other rights that vary from state to state. This warranty is void if damage or defect has resulted from accident, abuse, misuse or faulty repairs.

In no event will liability extend to any consequential, special, incidental or direct damage of any kind arising out of the use or misuse of this product. Some states do not allow the exclusion or limitation of incidental or consequential damages so the above exclusion or limitation may not apply to you.