

| BOM Table | | | | | | |
|-----------|--------------|------|---|-----------|-------------|-------|
| ITEM NO. | PART NUMBER | Rev. | Description | Material | FlameRating | Color |
| 1 | ZQ-06064B-01 | 1 | BASE, JUNCTION | PC | UL94-5VA | GRAY |
| 2 | INSERTS-4 | 0 | SELF-TAPPING INSERT: 10-32 UNF X .296 LG. | BRASS 360 | | |
| 3 | LABEL-104 | 0 | UL LABEL | | | |

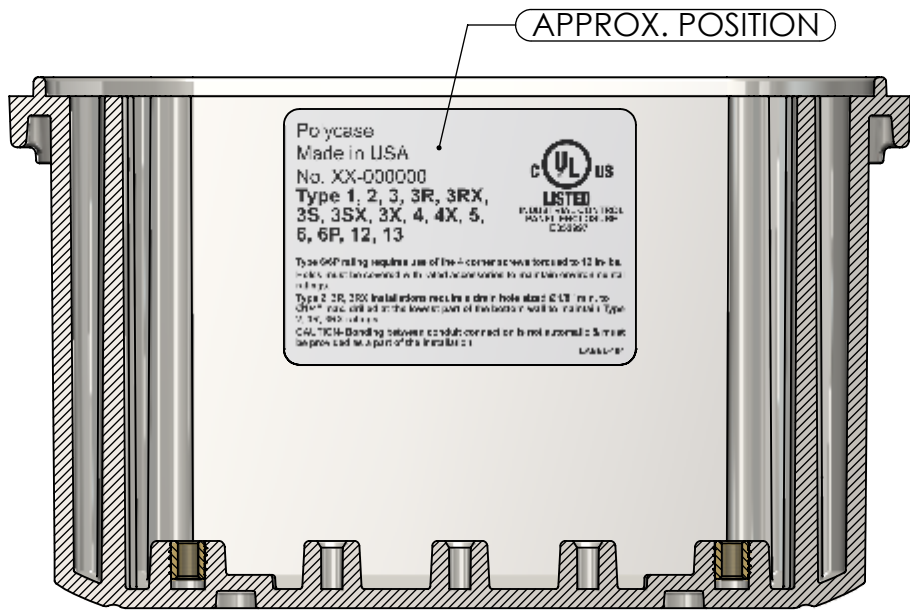

SECTION B-B

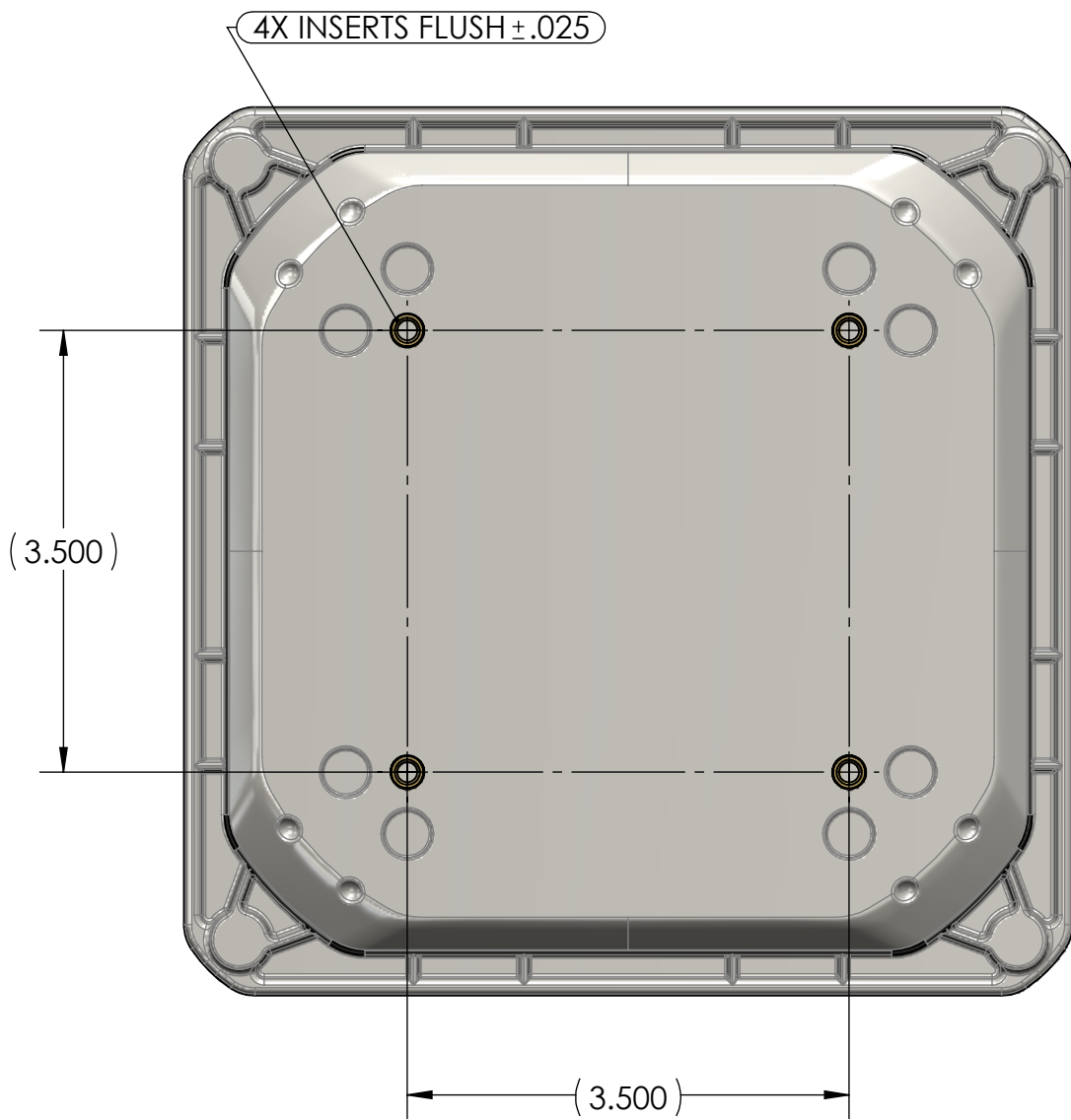
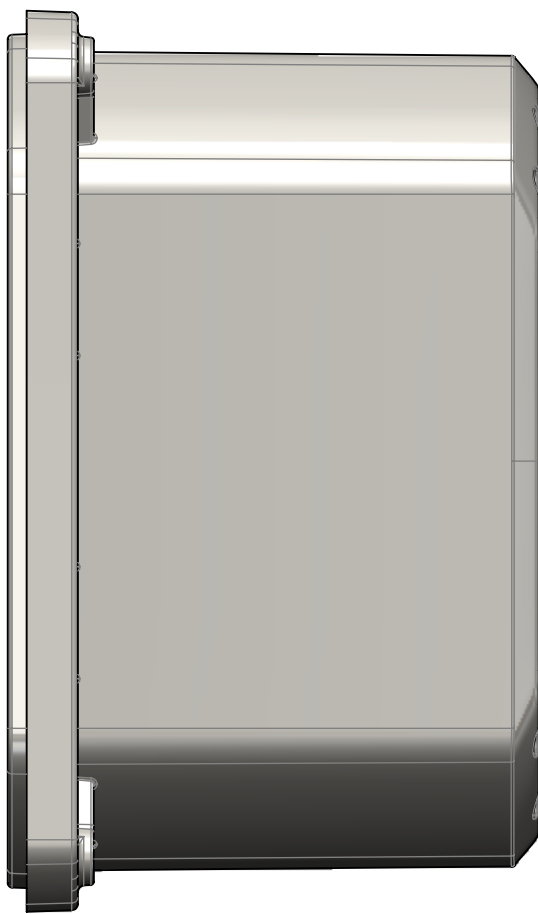
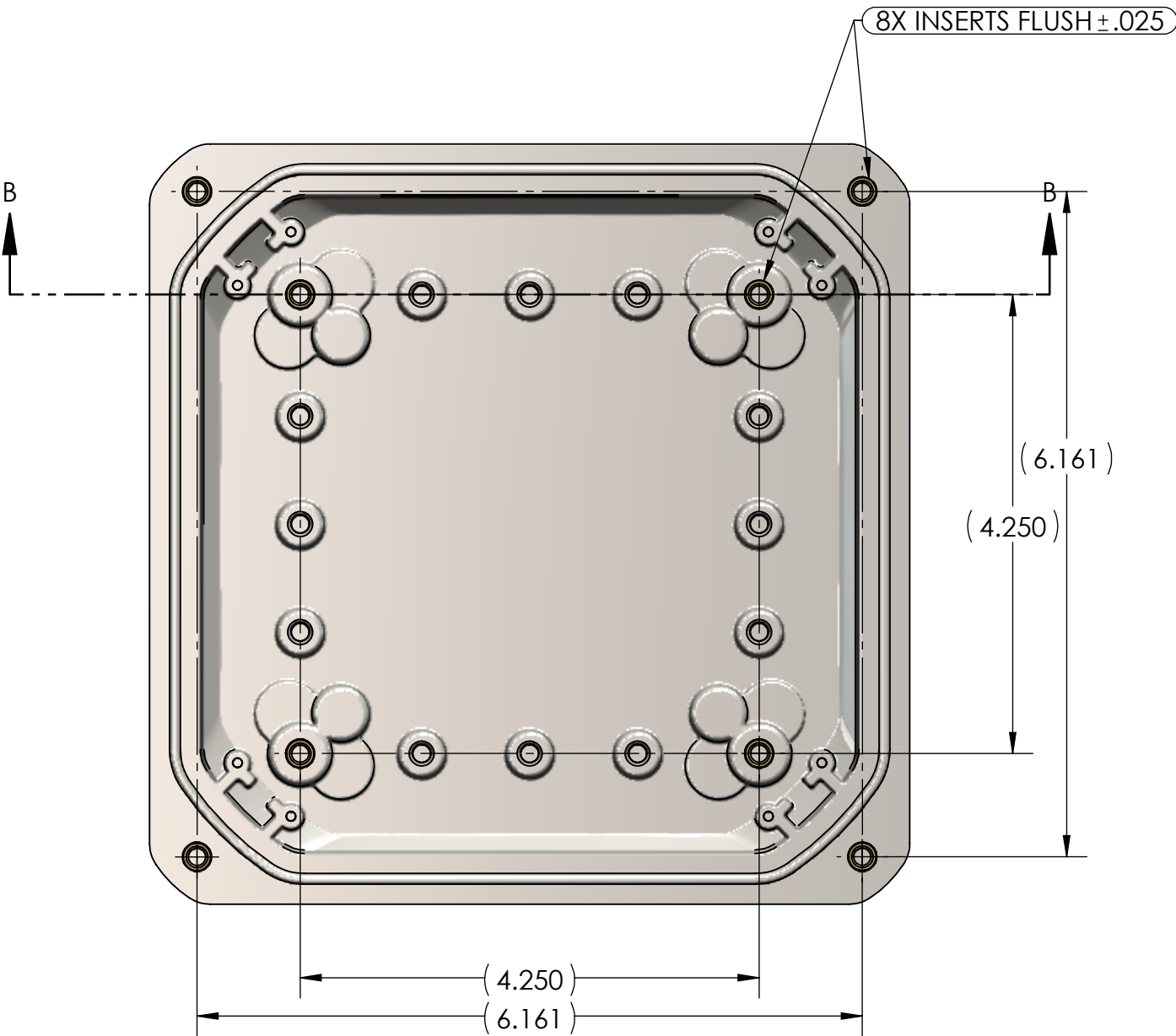
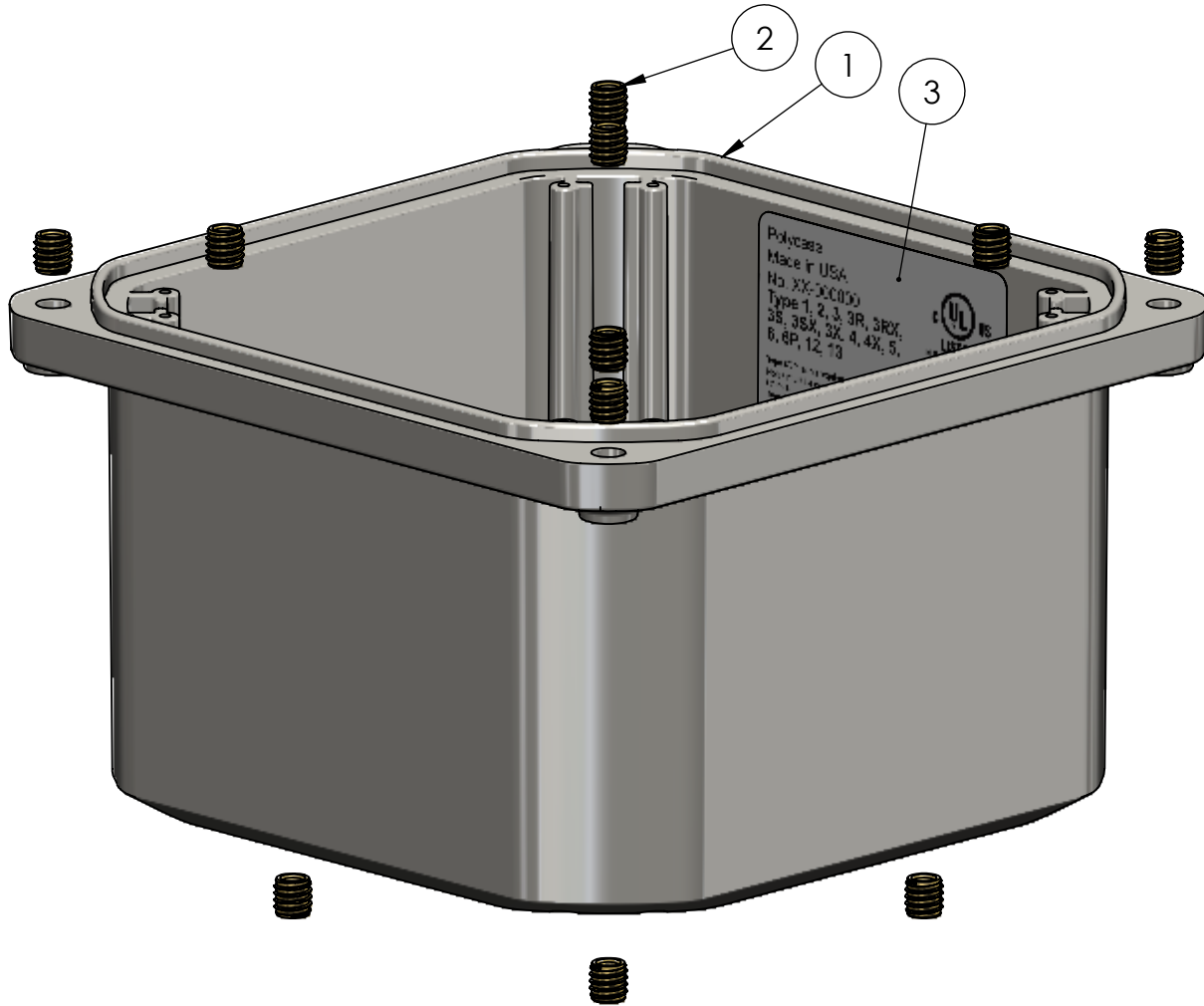

| REV. | COMMENT | ZONE | REVISED BY | CREATION DATE |
|------|---|------|----------------|---------------|
| 1 | ADDED -40-45 & -90-95, UPDATED FLAME RATING | | Douglas French | 7-29-2024 |
| 0 | | | Douglas French | 9-6-2022 |

UNLESS OTHERWISE SPECIFIED:
DIMENSIONS ARE IN: INCHES[mm]
TOLERANCES: ANGULAR: ±2°
TWO PLACE DECIMAL: ±.010
THREE PLACE DECIMAL: ±.005
PRINTED GRAPHICS: ±.010
PROPRIETARY AND CONFIDENTIAL
THE INFORMATION CONTAINED IN THIS
DRAWING IS THE SOLE PROPERTY OF
POLYCASE. ANY REPRODUCTION IN PART
OR AS A WHOLE WITHOUT THE WRITTEN
PERMISSION OF POLYCASE IS PROHIBITED.
CAD FILE: ZQ-06064BI

| | |
|---------------------------|------------|
| PART NO. ZQ-06064BI-01 | |
| MATERIAL | |
| FLAME RATING | SIZE |
| | C |
| DRAWN | NAME |
| CHECKED | D.M.F. |
| | 6/10/2019 |
| | 12/31/2999 |

polycase
1305 CHESTER RD. PARKWAY AVON, OHIO 44011-1083 U.S.A.
PH: 1-800-248-1233, 440-934-0444 FAX: 440-934-0088

SCALE: 1:1.5

REV 0

SHEET 1 OF 1