

Addition to Cool Cupz Drink Shop

Outdoor Wall Design Brief

New Addition to Brief

We added an air vent to the wall and we want to incorporate it into the wall design. Below you will see pictures of the air vent. We would like to have the air vent be like the front of an ice cream making machine (picture show below) - [If you have IG please see this video for an idea of what it looks like when Italian Ice comes out of the machine - https://www.instagram.com/reel/CcrlKxvJh7N/](https://www.instagram.com/reel/CcrlKxvJh7N/) .

We think it will be cool if the vent has ice cream flowing out and falling down to the bottom and splashing back up into a wave of yummy fun.

Please note we can paint the vent any color.





Wall Sizes

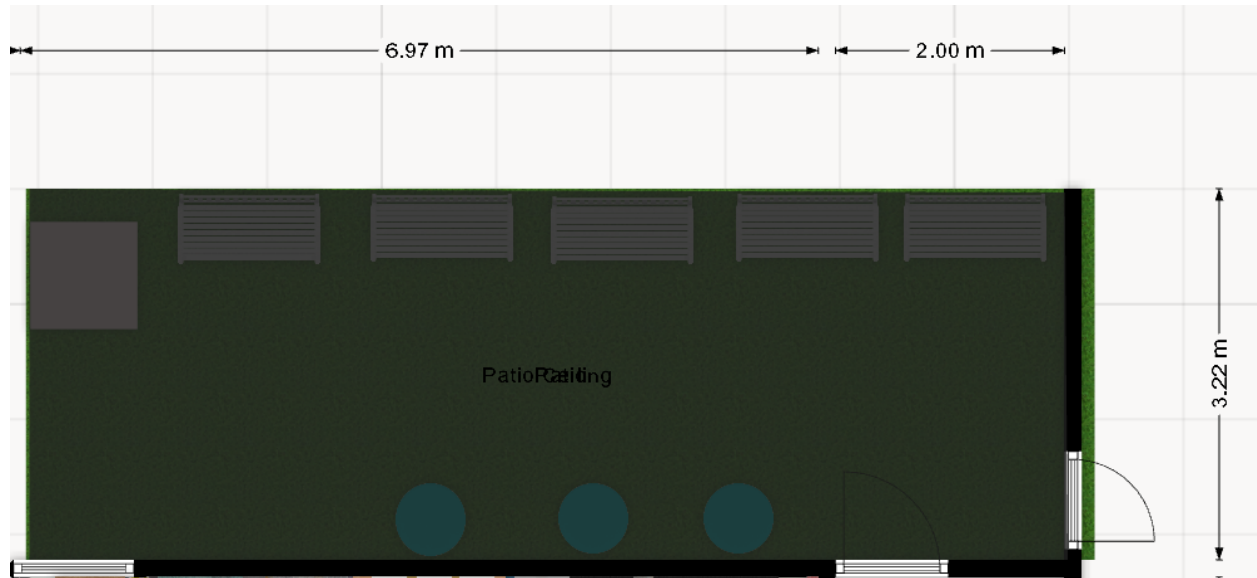

Wall Template

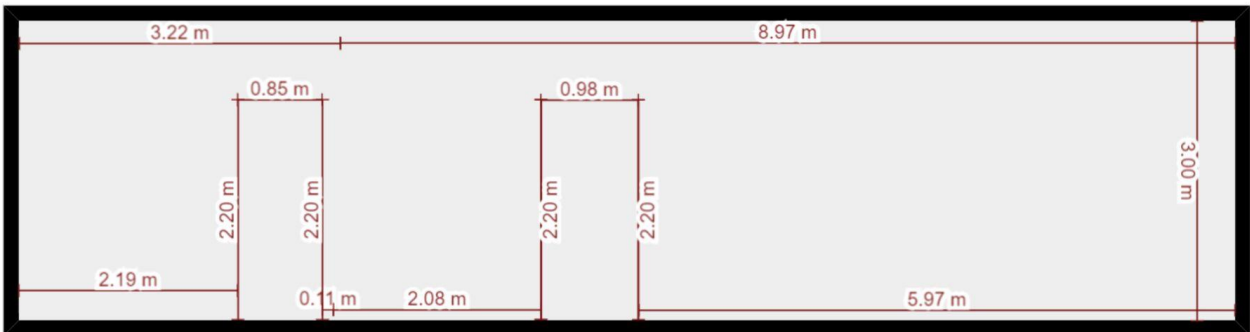

The big wall with the Cool Cupz logo is 8.97m long x 3m tall

The door is 2.08M from the wall on the left and the door dimensions are 0.98m x 2.2m

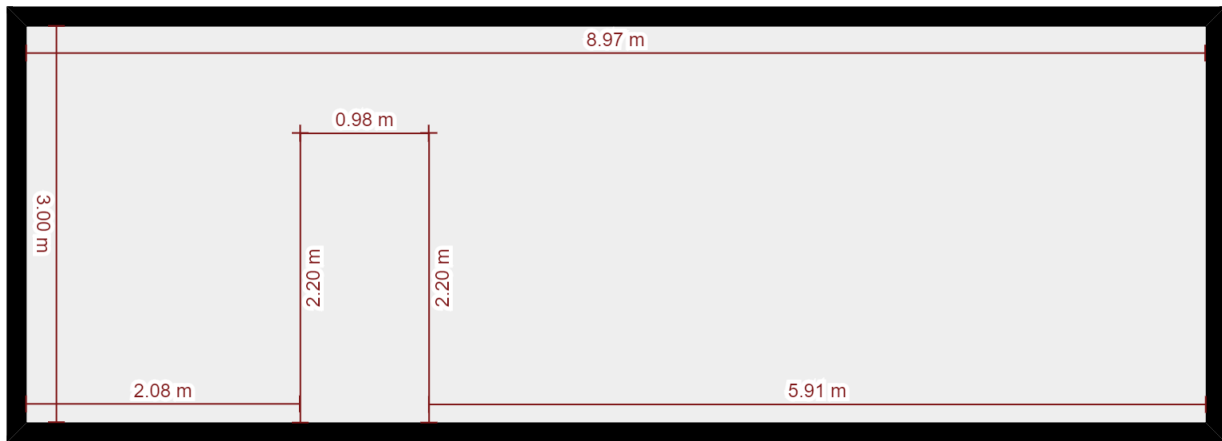

The small wall is 3.22m x 3m

The door is almost all the way in the corner and the door dimensions are 0.85m x 2.2m

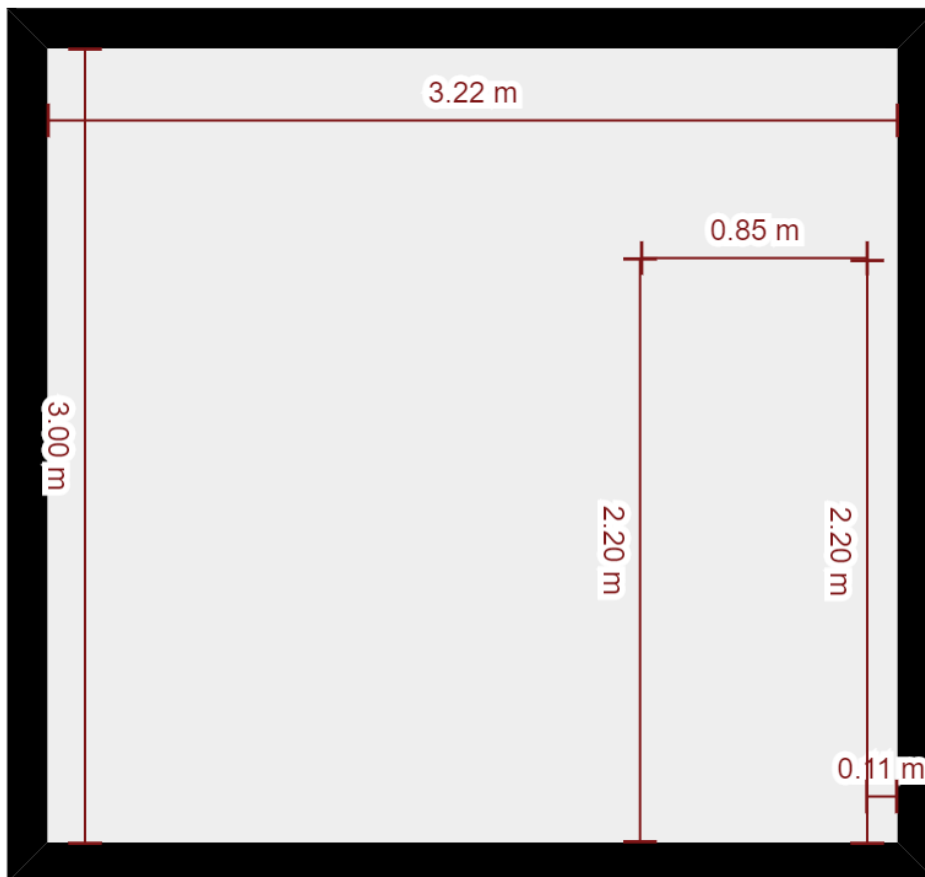

We look forward to your designs!

Thank You!